



INTERNATIONAL AFFAIRS

Address:

Rua Quatá 300, Vila Olímpia
04546-042, São Paulo – SP, Brasil
www.insper.edu.br
+55 11 4504 2760

Main contact international@insper.edu.br

International Experience's Team – Student Life

Renice Tombani – Head of Student Life
Andréia Ribeiro – Head of International Experience
Fernando Almeida – Outgoing Students
Kamila Barbosa – Incoming Students



ALL DEGREE PROGRAMS OFFERED AT INSPER

- Bachelor Degrees Programs – Business Administration, Economics, Computer Engineering, Mechanical Engineering, Mechatronic Engineering, Computer Science, and Law (Classes in Portuguese and English)
- Master in Business Management/Diploma (Classes in Portuguese)
- LL.M. and LL.C. Programs (Classes in Portuguese)
- Master (RES) Programs – Business, Economics and Public Policy (Classes in Portuguese)
- Executive MBA (Classes in Portuguese and Short-term in English)
- Ph.D. in Business and Economics (Classes in English)
- Advanced Programs - Finance, Communication and Journalism, Data Science and Decision, Public Management, Control and Accounting and Social Urbanism (Classes in Portuguese)
- Executive Education (Open enrollment, customized and online programs)

ACADEMIC CALENDAR

In Brazil, the academic year starts officially in January and ends in December.

The courses we offer in English and Portuguese in the 4th and 5th year of the undergraduate programs follow the academic calendar below:

SEMESTER CALENDAR

	Semester 2024.1 Dates* (Jan – June 2024)	Semester 2024.2 Dates* (Jul – Dec 2024)
Nomination Deadline	October 15 th , 2023	April 15 th , 2024
Application Deadline	October 30 th , 2023	April 30 th , 2024
Welcome Week	Jan 29 th to Feb 2 nd , 2024	Jul 29 th to Aug 2 nd , 2024
Beginning of Classes	Feb 5 th , 2024	Aug 05 th , 2024
Semester Finishes at	Jun 26 th , 2024	Dec 20 th , 2024

*Courses offered in the Masters, LL.M. and MBA programs (**only in Portuguese**) follow a different calendar, please specify to us if you need this information.*

APPLICATION PROCEDURES

Nominated students will receive information about Insper, application, required documents, accommodation, life in São Paulo, etc., after being nominated by their school.

LANGUAGE OF INSTRUCTION

Students do not need to speak Portuguese to study at Insper.
A variety of courses (20 to 30 per semester) are taught in English.

Courses are taught in English **or** Portuguese. Insper recommends exchange students to have at least a CEFR B2 level **of English**, but we do not require an English proficiency proof.

If your students plan to take courses in Portuguese, proficiency proof is compulsory. It can be a letter from the Home University attesting the student is able to take courses in Portuguese.

BRAZILIAN CULTURE & LANGUAGE WORKSHOP

Insper offers a Brazilian Culture and language Workshop, which is free of charge for international students. It involves interactive activities and classes, which will explore aspects of the Brazilian culture and a survival Portuguese course. Students from all levels of Portuguese are welcome to join. This program is aimed at students who had no prior contact with Portuguese. Students with intermediate levels are welcome to participate, but they may find it very basic.

COURSES AVAILABLE AND COURSE REGISTRATION

Program information may change every semester since the courses in English are offered in the 4th year and 5th of the undergraduate programs (elective courses).

The updated list of available courses for the each semester is published in the prior semester, , but you can check the list of courses in the last semesters as an example of what is offered, [click here](#).

For checking graduate courses (in Portuguese), please access Inspere' [WebSite](#).

Exchange students must attend a minimum number of courses this is compulsory as a national regulation – more information available at the Credit System section below.

LEARNING EXPECTATIONS AND CLASS ATTENDANCE



Classes at Inspere are very participative, and students are expected to contribute to class discussions and projects, seminars, lectures, and self-study, this is all part of their evaluation as well.

Class attendance in Brazil is **mandatory**. Students must attend a minimum of 75% of the courses in order to be approved. Any situation will be included in the 25% absence limit.

Classes size range from 20 to 90 students.

Assessments take place at different times - students can check the exact examination schedules through the school calendar system. Exams are mandatory (in class).

If a student misses an exam, an additional fee will be applied after it.

There are no retake exams at Inspere.

GRADING AND CREDIT SYSTEM – UNDERGRADUATE COURSES

Grading scale 0 – 10, where 5.0 is the minimum grade required for passing a course:

Group	Scale	Description of the grading system
APPROVED	9 – 10	Excellent
	8 – 8.9	Very Good
	7 – 7.9	Good
	6 – 6.9	Satisfactory
	5 – 5.9	Sufficient
NOT APPROVED	3.1 – 4.9	Fail
	0 – 3	Fail

Credit System:

Insper does not operate on the ECTS/Units credit system, our courses are *hour/lesson*, which include lectures and supervised activities. In order to assist institutions regarding the credit transfer, the information below is provided about the two categories of courses offered at Insper:

- **40 hours/lesson courses:**
 - one class per week
 - course workload: from 125 to 150 hours
 - we recommend the equivalence of 5 ECTS
- **80 hours/lesson courses:**
 - two classes per week
 - course workload: from 250 to 300 hours
 - we recommend the equivalence of 10 ECTS

To be registered as an exchange student at Insper **students must take at least 5 courses (of 40 hours/lesson – or a combination with 80 hours/lesson' courses)**, we do not recommend students to take more than 8 courses.

FACILITIES

Inspere has a modern and innovative Campus with two buildings. All infrastructure is available to students: classrooms, auditorium, restaurant, coffee shops, parking lot, Wi-Fi access, Student's Lounge, labs, sports facilities, and much more.

BUDDY PROGRAM

Buddies are regular Inspere students assigned to help international students during their stay in Brazil. All exchange students are assigned to a Buddy; their main goal is to make students enjoy the most of their experience in Brazil.

CAREER CENTER

Exchange students are welcome to visit and count with our career center to help them understand how the Brazilian job market works and to know more about internship opportunities. Since most of the courses are offered during the morning international students are able to look for internship opportunities during the afternoon period. If your student is interested on this kind of opportunity, we recommend that they contact us in advance.

CLUBS AND SOCIETIES

Inspere has more than 45 clubs and societies; exchange students are welcome to join them. From discussing politics, doing consultancy, organizing cultural activities, and playing sports, to building and competing with racecars, there are many great options for engaging and enjoying the best of the academic experience at Inspere.

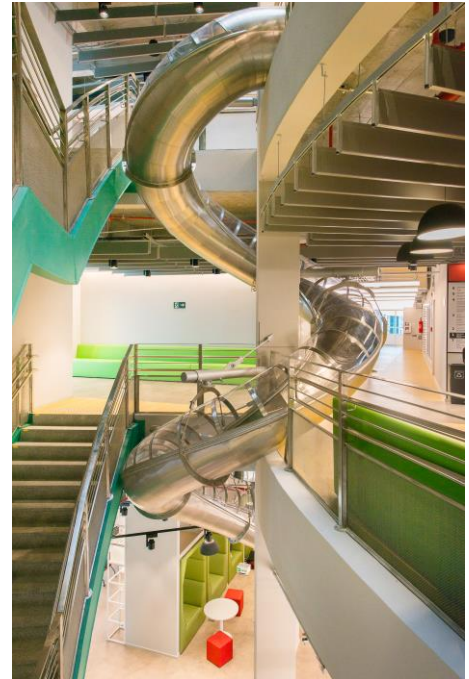

PRACTICAL INFORMATION

VISA

International exchange/visiting students must obtain a student visa at the Brazilian Embassy or Consulate in their home countries after receiving their letter of acceptance from Insper.

Please note that a tourist visa is not valid for permanence in Brazil as an international student.

Visas must be obtained **BEFORE** admission into Brazil. A tourist visa cannot be converted into a student visa once the student has left his/her country of origin. Students without student visas will not be enrolled at Insper.

[Click here](#) to see more information about visas to Brazil.

ACCOMMODATION

- Insper does not offer housing to students, but you can find information about housing options below:
 - <https://4student.com.br/home-eng> (most recommended)
 - <https://kasa.com.br> (very close to Insper, great services, very nice area, there are many International and local students living there already)
 - <https://uliving.com.br/en/sao-paulo/> (Jardins or Paulista)
 - <https://housi.com/>
 - <https://sharesl.com.br/en/home-en/>
 - <https://www.yuca.live/>
 - <https://www.facebook.com/groups/1062973057064965> (Housing Insper)

Insper is located at Vila Olímpia, one of São Paulo's delightful upper-class neighborhoods, the region hosts many of the world's largest and most renowned technology corporations and has therefore been endearingly nicknamed 'Silicon Valley São Paulo.' Considered one of the greatest centers of development in the city of São Paulo, Vila Olímpia infuses modernity and innovation with charm and variety, most visited by people who are constantly in search for the best that São Paulo has to offer. Vila Olímpia is also well known for its nightlife, with bars and nightclubs injecting energy into this region of São Paulo.

ARRIVAL DATE AND WELCOME WEEK



Exchange students must arrive **BEFORE** the Welcome Week, during it we will present the school, give information about the registration procedures, many activities happen during these days with international and local students, you will also learn more about the Brazilian culture and São Paulo.

It is also very important to arrive prior to classes in order to accommodate and adapt to the city, as well as finish the registration for the courses.

Presence at the Welcome Week is **MANDATORY!**

HEALTH INSURANCE

It is mandatory to present a health insurance policy to obtain the visa and to study at Insper.

A copy of the health insurance policy will be required upon arrival of the student at the Orientation Week.

We strongly recommend that students obtain health insurance that covers costs without the need for reimbursement, to avoid upfront payments before any necessary assistance during the exchange period.

LIVING EXPENSES AND MONEY

São Paulo is the largest city in South America, with more than 21 million habitants in its metropolitan area. The currency in Brazil is the Brazilian Real (R\$).

Opening an account in a Brazilian bank can take long for a foreign person, and we advise students to count on other sources of money during their stay here:

- **Prepaid Travel Cards (like WISE, Revolut, etc. are highly recommended)**
- Credit/Debit Cards
- Cash (not very recommended, but you can easily find a currency exchange store)

We estimate that the monthly cost may vary from EUR 950 to EUR 1.200 for a student to live in a single room around the Campus and to have a standard lifestyle in Sao Paulo (including transportation, food and leisure).

Fact Sheet 2024

Insper

Living Expenses (<u>per month</u>)	R\$ (Brazilian Reais)
Housing – single room (from R\$2700 to R\$4000)	3.800
Food	1.000
Transportation (R\$ 4,40 bus, subway and train ticket)**	300
Personal Expenses***	600
Total	5.700

Exchange rates can be checked on [Oanda](#) or on your preferred currency converter.

